

# CLARKE<sup>®</sup>

## **METALWORKER**



WARNING: Read these instructions before using the bender

### 610MM METAL FOLDER/BENDER

MODEL NO: CMF24C

PART NO: 7630077

## USER INSTRUCTIONS

ORIGINAL INSTRUCTIONS

GC12/24

---

## INTRODUCTION

---

Thank you for purchasing this CLARKE Metal Bender. Before attempting to use it please read this manual and carefully follow all instructions given. In doing so you will ensure the safety of yourself and that of others around you, and you can also look forward to the product giving you long and satisfactory service.

Dimensions D x W x H	135 x 700 x 150 mm		
Net Weight	11.2 kg		
Bending Capacity	Thickness-(mild steel) 1.0 mm (20 gauge)	Width 610 mm	Angle - 0-90°

---

## SAFETY PRECAUTIONS

---

As with all workshop equipment it is necessary to exercise caution when it is put to use, being aware of any associated or inherent dangers.

- Due to the weight of the metal folder, the help of an assistant may be beneficial during unpacking and mounting.
- **ALWAYS** wear gloves when handling sheet-metal with sharp edges.
- **ALWAYS** operate on a suitably strong bench with adequate light.
- Leave adequate working space around the folder for safe and convenient operation.
- **ALWAYS** check for signs of structural damage before starting work. **DO NOT** use if damage is found. Have repairs made only by a CLARKE service centre.
- **ALWAYS** ensure the workpiece is secure and properly positioned before applying pressure.
- **ALWAYS** keep hands and fingers away from moving parts that may pinch.
- **NEVER** use extension tubes to increase the length of the handles. Excessive effort can cause damage and/or accidents.
- **NEVER** attempt to bend materials which exceed the sizes stated above.

Failure to heed these warnings may result in damage to the equipment or personal injury.

## ENVIRONMENTAL CONSIDERATIONS

If disposing of scrap metal, **DO NOT** dispose of with general waste. Metal products and scrap should be taken to your local civic amenity site for the recycling of metal products according to local regulations.

## METHOD OF USE

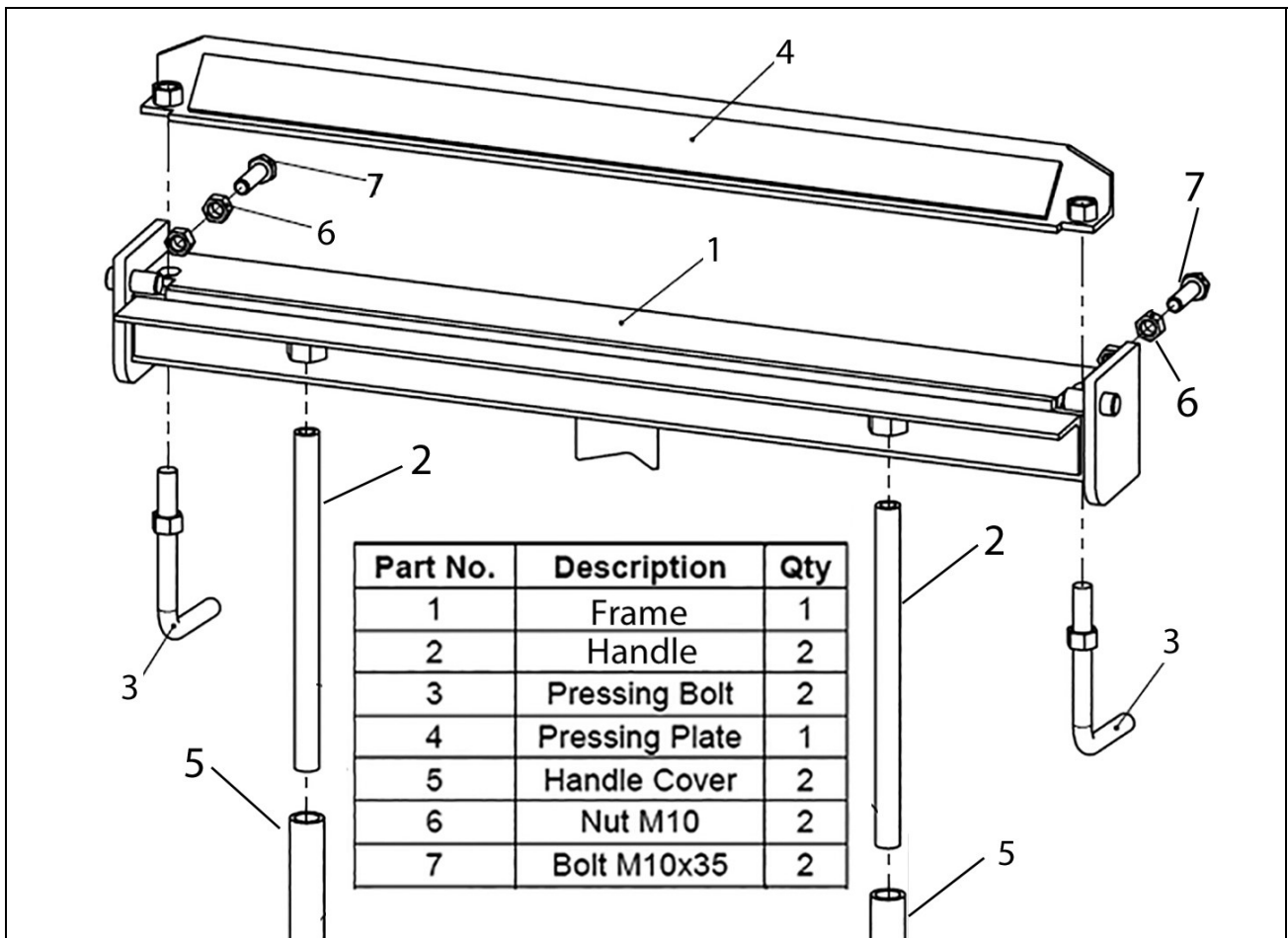

Mount the Metal Folder in a vice, at a height which allows easy operation taking into account the nature of the work with the handles pointing towards you.

**WARNING: NEVER EXCEED THE MAX BENDING CAPACITY (1.0mm MATERIAL).**

1. Lower the handle until the moving plate becomes parallel to the workbench.
2. Turn the bolt (7) to adjust the gap between the front edge of the pressing plate (4) and the moving plate to the required radius and tighten the nut (6).
3. Position the workpiece on the supporting plate and the moving plate so that the edge to be bent, lines up with the back edge of the supporting plate.
4. Place the pressing plate (4) on top of the supporting plate so that the back edge of the Pressing Plate lines up flush with the back edge of the Supporting Plate.
5. Turn the handle (2) until the pressing plate (4) presses the workpiece
6. Raise the two handles (2) to bend the material.

**NOTE:** Experiment with scrap pieces.

**WARNING: WHEN BENDING SHEET METAL, KEEP YOUR HANDS CLEAR OF THE SUPPORTING AND MOVING PLATE TO AVOID INJURY.**

# A SELECTION FROM THE VAST RANGE OF

# Clarke®

## QUALITY PRODUCTS



**AIR COMPRESSORS**  
From DIY to industrial, Plus air tools, spray guns and accessories.

**GENERATORS**  
Prime duty or emergency standby for business, home and leisure.

**POWER WASHERS**  
Hot and cold, electric and engine driven - we have what you need

**WELDERS**  
Mig, Arc, Tig and Spot. From DIY to auto/industrial.

**METALWORKING**  
Drills, grinders and saws for DIY and professional use.

**WOODWORKING**  
Saws, sanders, lathes, mortisers and dust extraction.

**HYDRAULICS**  
Cranes, body repair kits, transmission jacks for all types of workshop use.

**WATER PUMPS**  
Submersible, electric and engine driven for DIY, agriculture and industry.

**POWERTOOLS**  
Angle grinders, cordless drill sets, saws and sanders.

**STARTERS/CHARGERS**  
All sizes for car and commercial use.



## PARTS & SERVICE: 0208 988 7400

**Parts Enquiries**  
[Parts@clarkeinternational.com](mailto:Parts@clarkeinternational.com)

**Servicing & Technical Enquiries**  
[Service@clarkeinternational.com](mailto:Service@clarkeinternational.com)

SALES: UK 01992 565333 or Export 00 44 (0)1992 565335

**Clarke** INTERNATIONAL Hemnall Street, Epping, Essex CM16 4LG  
[www.clarkeinternational.com](http://www.clarkeinternational.com)